

# 6000 SF LIGHT COMMERCIAL INDUSTRIAL SPACE FOR LEASE

Ideal Gilroy location. Open space with 2 restrooms and ground level loading doors. Approximately 19' ft clear ceiling height. Suitable for many types of tenants/businesses. Convenient parking. Easy access to the 101 freeway.



160 PIERCE ST. GILROY, CA 95020

CONTACT

JOE GIGANTINO  
JOE@WORKOUT.COM PH: (408) 605 4840

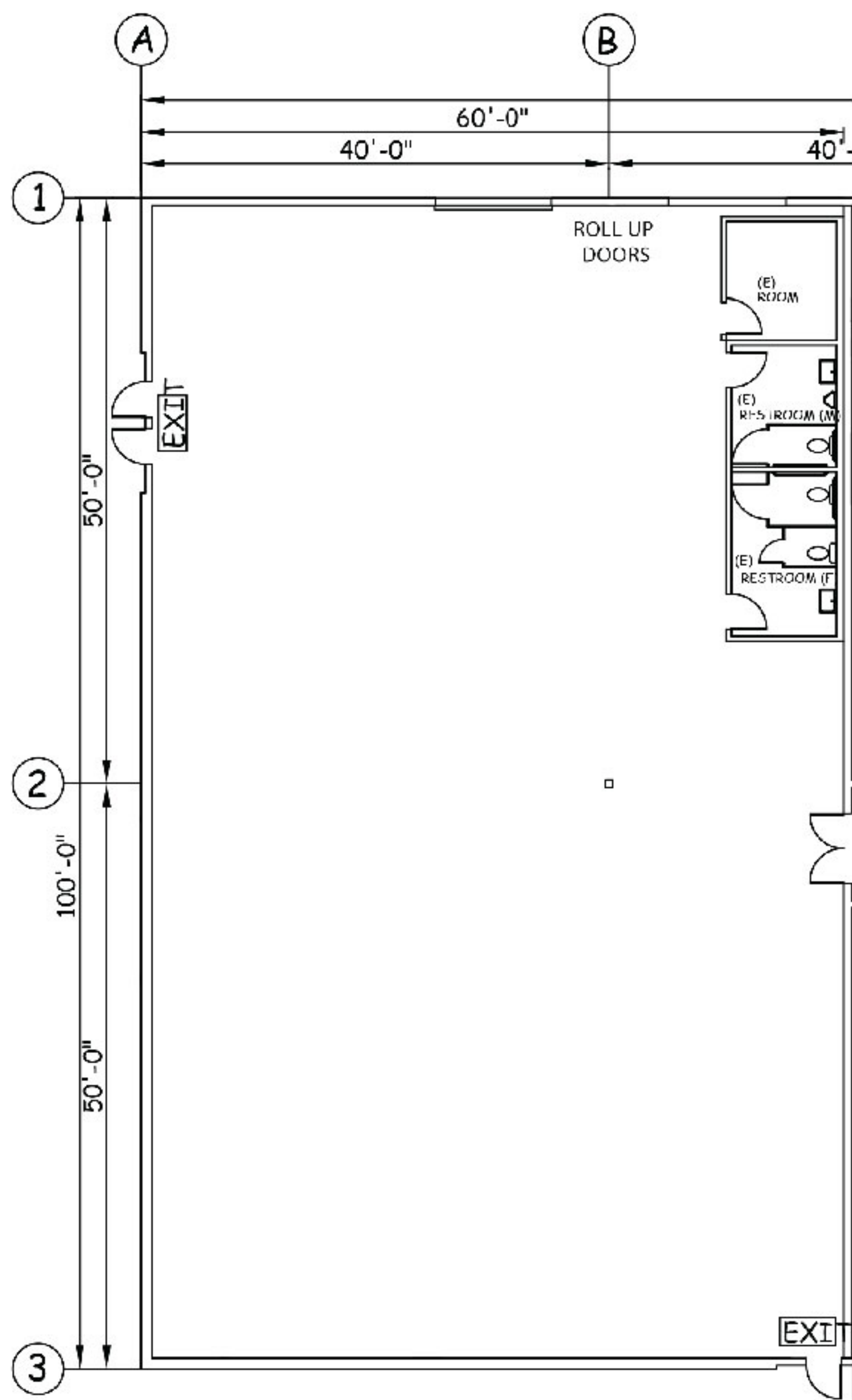

160 PIERCE ST. GILROY, CA 95020

CONTACT

JOE GIGANTINO  
 JOE@WORKOUT.COM PH: (408) 605 4840



**160 PIERCE ST.  
GILROY CA**

**160 PIERCE ST. GILROY, CA 95020**

**CONTACT**

**JOE GIGANTINO  
JOE@WORKOUT.COM PH: (408) 605 4840**